

CORIOLIS MASS FLOW METER

FA-U SERIES - FLANGE TYPE U VERSION

Flow Measurement
& Monitoring



DESCRIPTION

The KF910 Coriolis mass flow meter can measure the flow of ordinary conductive liquid, but also can be used for the volume flow of pure water and gas-liquid two-phase suspension liquid. It offers strong anti-interference ability and high measurement accuracy. The flow signal is linear to the average flow rate and is not affected by changes in fluid density, viscosity, temperature, pressure and conductivity. The FA series uses flange connection. Widely used in petroleum, chemical industry, metallurgy, textile, pharmaceutical, food and beverage, paper, electricity, urban water supply / drainage and environmental protection, etc.

TECHNICAL FEATURES

FEATURES

- ✓ Flange connection - U version
- ✓ Display of mass flow, mass totalizer flow, cubic flow, cubic totalizer flow, density
- ✓ High accuracy and repeatability
- ✓ 4-20mA, frequency, pulse output
- ✓ Communication: RS485/HART
- ✓ Explosion Grade: Ex d IIC T6 Gb

DN size	DN15 to DN50
Material	316L
Accuracy	0.1, 0.15, 0.2, 0.3
Velocity	0.3m/s to 10m/s
Working temperature	≤ 100°C for compact version/ 100 to 125°C (optional)
Working pressure	0.6 Mpa to 4.0 Mpa (based on size)
IP	IP65, IP67 (transmitter), IP68 (remote)
Output	4-20mA, frequency, pulse
Power supply	220VAC/24VDC (universal power supply)
Installation	Compact
Flange standard	DIN, ANSI, JIS
Display	OLED
Decimal	3
Display unit	Mass flow: kg/s, kg/m, kg/h, t/s, t/m, t/h Mass totalizer flow: kg, t Cubic flow: L/s, L/m, L/h, m³/s, m³/m, m³/h Cubic totalizer flow: L, m³ Density: g/cm³, g/L, kg/L, kg/m³
Communication	RS485/HART
Explosion grade	Ex d IIC T6 Gb



FLOW RANGE

DN (mm)	Flow Range (kg/h)	Zero Stability (kg/h)	Accuracy
15	300 - 3000	0.25	0.10, 0.15 0.20, 0.30
25	800 - 8000	0.75	
40	3200 - 32000	3.00	
50	3500 - 35000	3.20	

DIMENSION/DRAWING

U-Shape Tube Design

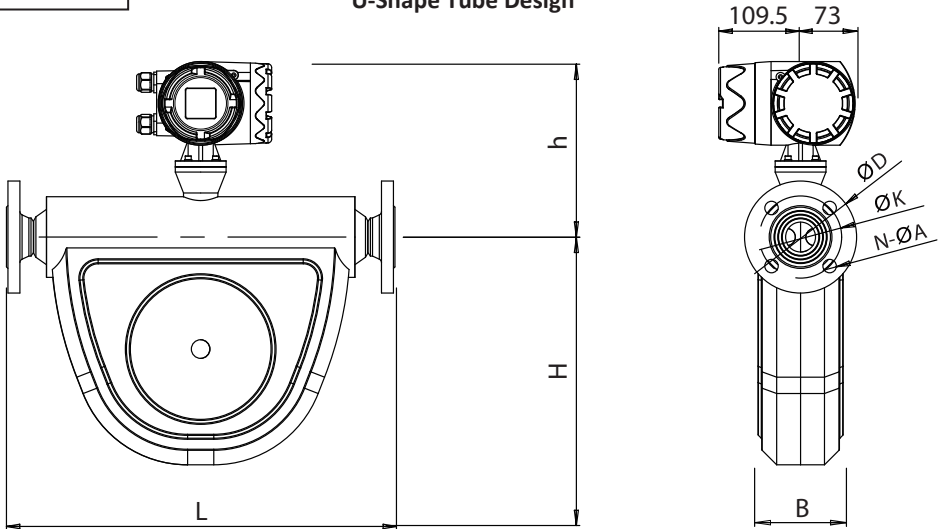

DN (mm)	Pressure	L (mm)	D (mm)	K (mm)	n-ØA (mm)	B (mm)	H (mm)	h (mm)
15	PN40	304	95	65	4-14	80	190	202
20		330	105	75	4-14	80	190	202
25		420	115	85	4-14	90	230	214
32		430	140	100	4-18	90	230	214
40		520	150	110	4-18	103	303	226
50		532	165	125	4-18	103	303	226

