

ELECTROMAGNETIC FLOW METER

IA SERIES - ECONOMICAL TYPE

Flow Measurement  
& Monitoring



DESCRIPTION

The Electromagnetic Flowmeters can be used to accurately measure the flowrate of non-corrosive medium, such as liquids, treated water which has an electrical conductivity greater than 20  $\mu$  S/cm.

IA Integral Type is a flow measurement system in a compact design which integrates the primary and signal converter.

IA Remote Type flow measurement system consists of a flowmeter primary and remote mounted converter.

TECHNICAL FEATURES

FEATURES

- ✓ Whole welded structure
- ✓ Good sealing performance
- ✓ Zero-point stability
- ✓ Small power consumption
- ✓ Simple and reliable, no moving parts inside; virtually no pressure loss
- ✓ Low-frequency square wave, anti-jamming performance
- ✓ User friendly, easy maintenance.

<b>Diameter</b>	DN25/ DN50 / DN80 / DN100
<b>Electrode</b>	316L / Hc
<b>Liner</b>	Polybutylene Terephthalate
<b>Body</b>	Carbon steel
<b>Connection</b>	Wafer clamp type
<b>Medium</b>	Conductive liquids
<b>Conductivity</b>	$\geq 20 \mu$ S/cm
<b>Accuracy</b>	$\pm 0.5\%$ M.V
<b>Operation Temperature</b>	-25 to 60°C
<b>Operation Pressure</b>	6 Bar Max
<b>Protection class</b>	IP65, IP67
<b>Output</b>	4-20mA / Frequency / Pulse output signal
<b>Communication</b>	RS485 Modbus /HART (as option)
<b>Power supply</b>	240V AC (50/60Hz)
<b>Installation type</b>	Compact / Remote



**DIMENSION/DRAWING**

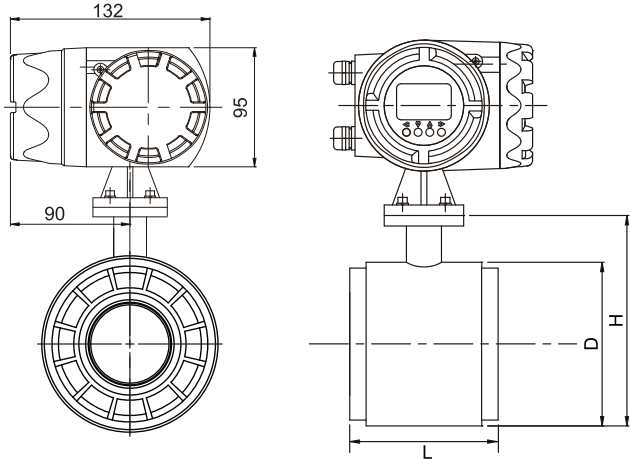

**Compact Type**

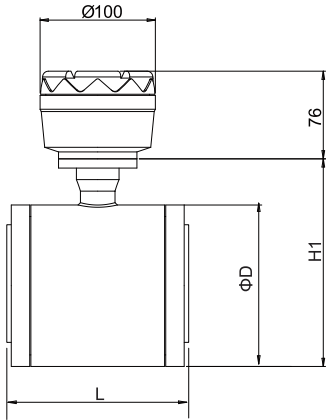

**Remote Type**

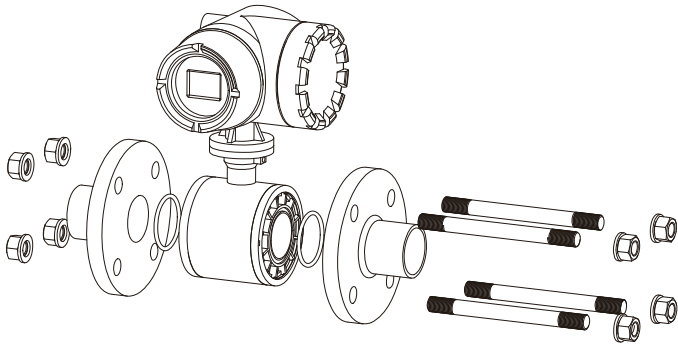

**Additional Mounting Accessories**

DN (mm)	L (mm)	D (mm)	H (mm)	Stud Bolt
25	68	72	113	4-M12*138
50	95	108	148	4-M16*184
80	110	138	178	8-M12*200
100	130	158	198	8-M12*220

**Additional Accessories**

DN (mm)	DN (inch)	Mounting Accessories Set
		Description
25	1"	PVC Flange O-Ring SUS 304 Stud Bolt, Nuts & Washer
50	2"	
80	3"	
100	4"	

